

DECIDUOUS TREE PLANTING
NO SCALE

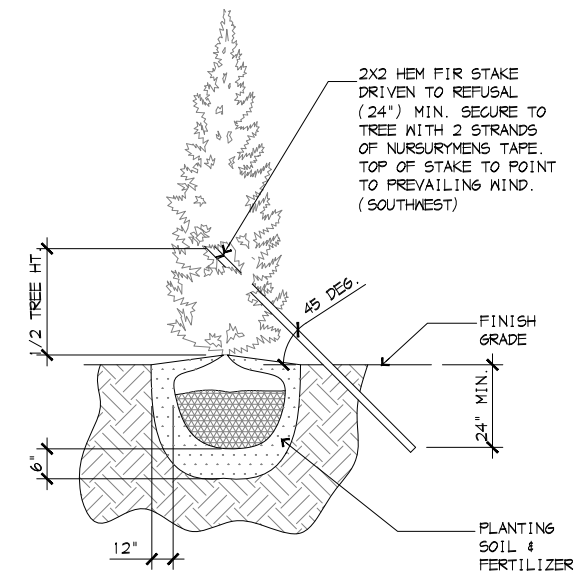

EVERGREEN TREE PLANTING
NO SCALE

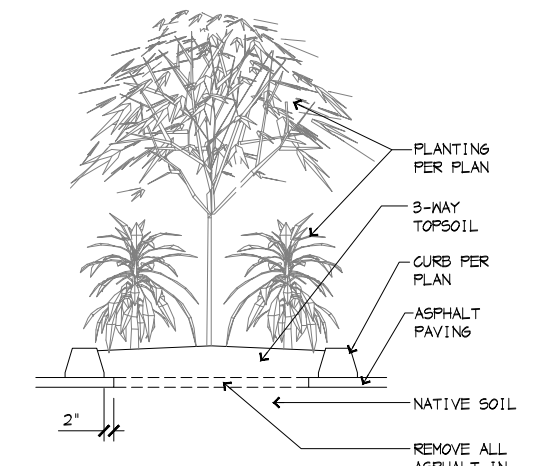

PLANTER DETAIL
NO SCALE

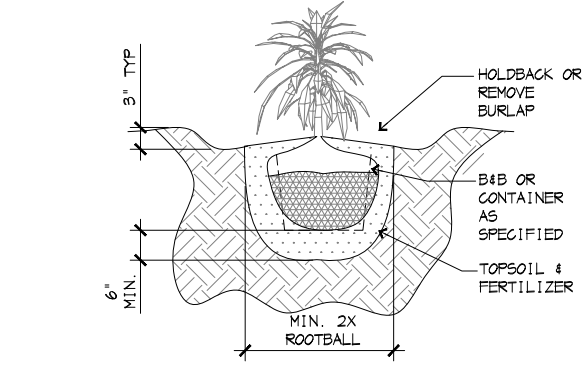

SHRUB PLANTING
NO SCALE

PLANTING DETAILS
NTS

| PLANTING SCHEDULE | | | | | |
|-------------------|----------|------------------------------|--------------------|---------|-------------------------------------|
| SYMBOL | QUANTITY | BOTANICAL | COMMON | SIZE | REMARKS |
| | 3 | ACER FREEMANII | AUTUMN BLAZE MAPLE | 2" GAL. | MIN 6' TALL AT PLANTING |
| | 6 | TILIA GORDATA | LITTLE LEAF LINDEN | 2" GAL. | MIN 6' TALL AT PLANTING |
| | 10 | RHODODENDRON SCHLIPPENBACHII | ROYAL AZALIA | 2 GAL. | 24" TALL |
| | 4 | PRUNUS LAUROGERASUS | OTTO LUYKEN | 2 GAL. | 24" TALL |
| | 52 | PRUNUS LAUROGERASUS | OTTO LUYKEN | 2 GAL. | 24" TALL MIXED VARIETY |
| | 3 | CEDRUS GENUS | CEDAR TREE | - | EXISTING TO REMAIN |
| | 3 | - | CEDAR OR PINE TREE | - | TO BE REMOVED |
| | 3 | ACER RUBURN | RED MAPLE TREE | 2 GAL. | 12-TO 15-FOOT MIN. HT. SEE NOTE: 13 |
| | 22 | BERBERIS THUNDERBII 'MARIA' | SUNJOY | | 3 FOOT HIGH |
| | AS REQ'D | ARCTOSTAPHYLOS UVA-URSI | KINNIKINNIK | 4" POTS | 24" O.C. |

NOTE:
AN IRRIGATION PLAN IS REQUIRED. THE IRRIGATION PLAN IS A DEFERRED PERMIT AND SHALL BE DONE BY A LANDSCAPING PROFESSIONAL DURING CONSTRUCTION.

TREE & SHRUBS PLANTING
NO SCALE

- BACKFILL MIX FOR PLANTING TREES, SHRUBS AND GROUND COVER SHALL BE: ONE PART BY VOLUME OF 3-WAY TOPSOIL MIXED WITH ONE PART NATIVE SOIL.
- PLANTER AREAS TO RECEIVE 3-WAY TOPSOIL.
- ALL TREES, SHRUBS AND GROUND COVER SHALL BE FERTILIZED WITH AGRO 4-2-2 TRANSPLANTER OR EQUAL AT PLANTING TIME.
- AFTER PLANTING OF ALL PLANTS, MULCH ALL AREAS WITH A MINIMUM OF 2" OF MEDIUM FINE BARK MULCH.
- OWNER TO APPROVE PLANTING PRIOR TO INSTALLATION.
- PLANT TYPES MAY BE SUBSTITUTED DUE TO AVAILABILITY WITH SIMILAR SPECIES AND VARIETIES.
- LANDSCAPING CONTRACTOR RESPONSIBLE FOR MAINTENANCE DURING CONSTRUCTION PERIOD.
- ALL PLANTS TO BE HEALTHY AT THE TIME OF PLANTING AND GUARANTEED FOR ONE FULL YEAR OR UNTIL THE NEXT SPRING (WHICHEVER IS GREATER).
- ALL BEAUTY BARK TO BE PLACED ON NEED CLOTH BARRIER.
- REMOVE EXISTING WEEDS AND GRASSES PRIOR TO PLANTING LANDSCAPE AREAS.
- SEE DETAILS FOR PLANTING AND LANDSCAPING DETAILS.
- A SPRINKLER SYSTEM IS REQUIRED FOR THIS PROJECT. DESIGN AND INSTALLATION OF THE SYSTEM WILL BE THE RESPONSIBILITY OF THE BIDDING CONTRACTOR. GENERAL CONTRACTOR TO SUBMIT SHOP DRAWINGS TO THE ARCHITECT PRIOR TO INSTALLATION OF THE SYSTEM.
- AS PER SECTION 221.06.200 SPECIAL STREET LANDSCAPING SW TO 196TH STREET SW, RED MAPLE TREES TWO-AND-ONE-HALF-TO THREE-INCH MINIMUM CALIPER SIZE, 12-TO 15-FOOT MINIMUM HEIGHT, 25 FEET ON CENTERS WITH BRANCHES ELIMINATED TO A HEIGHT OF SIX FEET WHERE NECESSARY TO PREVENT SIGHT OBSTRUCTION; PLUS LAWN, EXCEPT THAT IVY, CREEPING ST. JOHNSWORT, OR KINNIKINNIK, SPACED SO AS TO ACHIEVE 50% GROUND COVER WITHIN TWO YEARS, SHALL BE ALLOWED ON PORTIONS DEMONSTRATED TO BE TOO STEEP FOR ADEQUATE LAWN MAINTENANCE.

LYNNWOOD MUNICIPAL CODE
REQUIRED LANDSCAPE NOTES

- LMC 21.06.300
General landscaping standards.
- A. General Site Preparation.
- Compacted Soil. During site preparation soil must be loosened or uncompacted in landscape areas where necessary due to compaction. Soil must be uncompacted, at minimum, down to 24 inches below surface grade in any landscape buffer, street frontage, or parking lot landscaping areas. Depth of soil that is loosened or uncompacted may be less if recommended by the qualified landscape professional. Where necessary soil amendments may be added from a verified source.
 - Root Barriers. Trees planted within 10 feet of a public street, sidewalk, paved trail, or walkway must be a deep-rooted species and must be separated from hardscapes by a root barrier to prevent physical damage to public improvements.
- B. General Plant Standards (Groundcover, Shrubs, and Trees).
- Plant Selection. Plants must be appropriate for the Puget Sound lowland region. Permitted plants and trees are allowed as described below.
 - Prohibited Plants. Plants listed by the Washington State Noxious Weed Control Board in their Noxious Weed List or subsequent document, or commonly known as invasive species, are prohibited from being planted in the city.
 - General Tree Standards.
 - Trees must be selected from the city's Tree Preservation and Protection Guidelines and meet the following standards:
 - Deciduous and evergreen trees must be a minimum of eight feet in height and have a caliper size of at least two inches at time of planting.
 - Trees must be planted so that, when they reach maturity, there will be a minimum of 10 feet of clearance on-center between trees.
 - Tree selection within all landscape areas, including street trees, must comply with Snohomish PUD utility requirements, other existing utilities (stormwater, water, and wastewater conveyance systems), lighting, existing and proposed signage, adjacent trees, existing natural features, tree root growth, solar access, planting area width, and overall height of selected trees at maturity.
 - Tree branches must be trimmed to provide a minimum of six feet of clearance measured from the ground to the branch to prevent sight and pedestrian obstructions. Tree branches must be trimmed to provide eight feet of clearance when overhanging vehicular use areas.

| | |
|-------|-----------------------------------|
| For: | PRE-DEVELOPMENT MEETING SUBMITTAL |
| Date: | 20 APRIL 2023 31 MAY 2023 |
| | DESIGN REVIEW |



2812 Colby Avenue
Everett WA 98201
(425) 252-2153 p
www.2812architecture.com

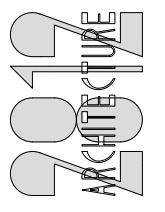

A New Office Building For
CHO OFFICE BUILDING
4820 196th Street
Lynnwood, Washington

| | |
|-------------|----------|
| Drawing: | L1.1 |
| Job Number: | 23c-4493 |