

**TOP VIEW**

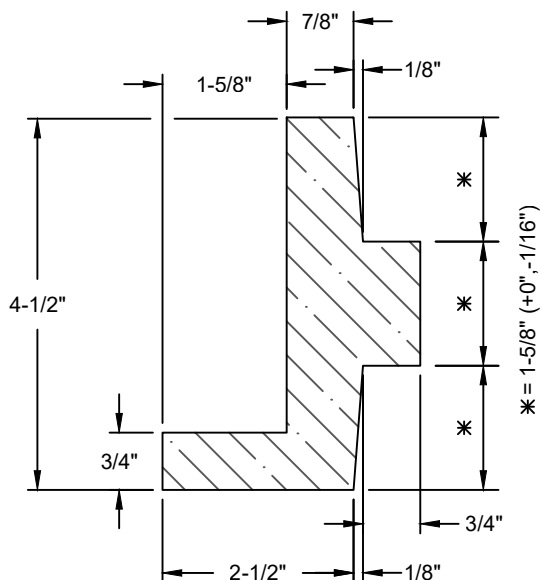

**NOTES:**

1. FRAME TO BE EAST JORDAN #7756 OR EQUAL.
2. MATERIAL USED SHALL BE CAST IRON PER ASTM-A48, CLASS 35. FRAME SHALL HAVE A BITUMINOUS COATING APPLIED.
3. WHEN A LOCKING GRATE OR COVER IS REQUIRED THE FRAME SHALL BE FABRICATED SO AS TO ACCEPT TWO (2) 5/8" STAINLESS STEEL SOCKET HEAD CAP SCREWS OF GRATE OR COVER.
4. NON SLIP LID REQUIRED FOR CTACH BASINS WITHIN WALKING PATHS, TYP.